



## Home Farm, Luton Road

Markyate, AL3 8QB

Beautiful Home Farm - set in grounds of circa 10 acres and to include a two bedroom, self-contained annexe - is a fabulous family home, offering a huge amount of living and entertaining space, together with uninterrupted views across open countryside. The annexe is ideal for multi-generational living or staff accommodation, for example. There are a number of outbuildings, including a gym and two barns. Additional benefits such as a workshop and hot tub.

**Guide price £4,500,000**

# Home Farm, Luton Road

## Markyate, AL3 8QB



- Circa 8,500 sq ft
- Immaculately presented throughout
- Outbuildings include gym & two barns
- Self-contained Annexe
- Large Garage with Workshop
- Hot tub
- Grounds of circa 10 acres
- Multiple outdoor seating areas
- Rural location

### Lounge

32'10" x 24'11" (max) (10.01 x 7.60 (max))

### Kitchen / Breakfast / Living Room

34'0" x 22'3" (max) (10.37 x 6.79 (max))

### Dining Room

23'10" x 15'2" (7.28 x 4.63)

### Cloakroom One

### Family Room

20'8" x 15'5" (6.30 x 4.72)

### Study

20'6" (max) x 11'3" (6.27 (max) x 3.45)

### Play Room

15'5" (max) x 13'7" (max) (4.72 (max) x 4.15 (max))

### Cloakroom Two

### Principal Bedroom

15'3" x 13'0" (4.67 x 3.97)

### Dressing Room

### En-suite Bathroom

### Bedroom Two

17'10" x 14'5" (max) (5.46 x 4.40 (max))

### En-suite Bathroom

### Bedroom Three

17'10" x 15'2" (5.46 x 4.63)

### En-suite Shower Room

### Bedroom Four

15'5" x 13'0" (4.72 x 3.97)

### Bedroom Five

12'3" x 11'9" (3.74 x 3.60)

### Shower Room

### Bedroom Six

### Games Room

50'11" x 12'9" (15.54 x 3.91)

### Annexe - Self Contained

### Living / Dining Room

21'9" x 17'5" (6.64 x 5.32)

### Kitchen / Breakfast Room

15'8" x 14'2" (4.79 x 4.32)

### Bedroom One

17'5" x 14'9" (5.32 x 4.51)

### En-suite Shower Room

### Bedroom Two

11'5" x 10'6" (3.50 x 3.21)

### Bathroom

### Garage

32'1" x 23'9" (9.78 x 7.25)

### Workshop

### Wine Cellar

### Store

### Shower Room

### Outbuildings

### Main Barn

29'0" (max) x 23'9" (max) (8.85 (max) x 7.25 (max))

### Barn

18'5" x 7'10" (5.62 x 2.41)

### Gym

17'8" x 13'0" (5.41 x 3.98)

### Elevated Summer House

11'10" x 10'10" (3.61 x 3.31)









Floor Plan

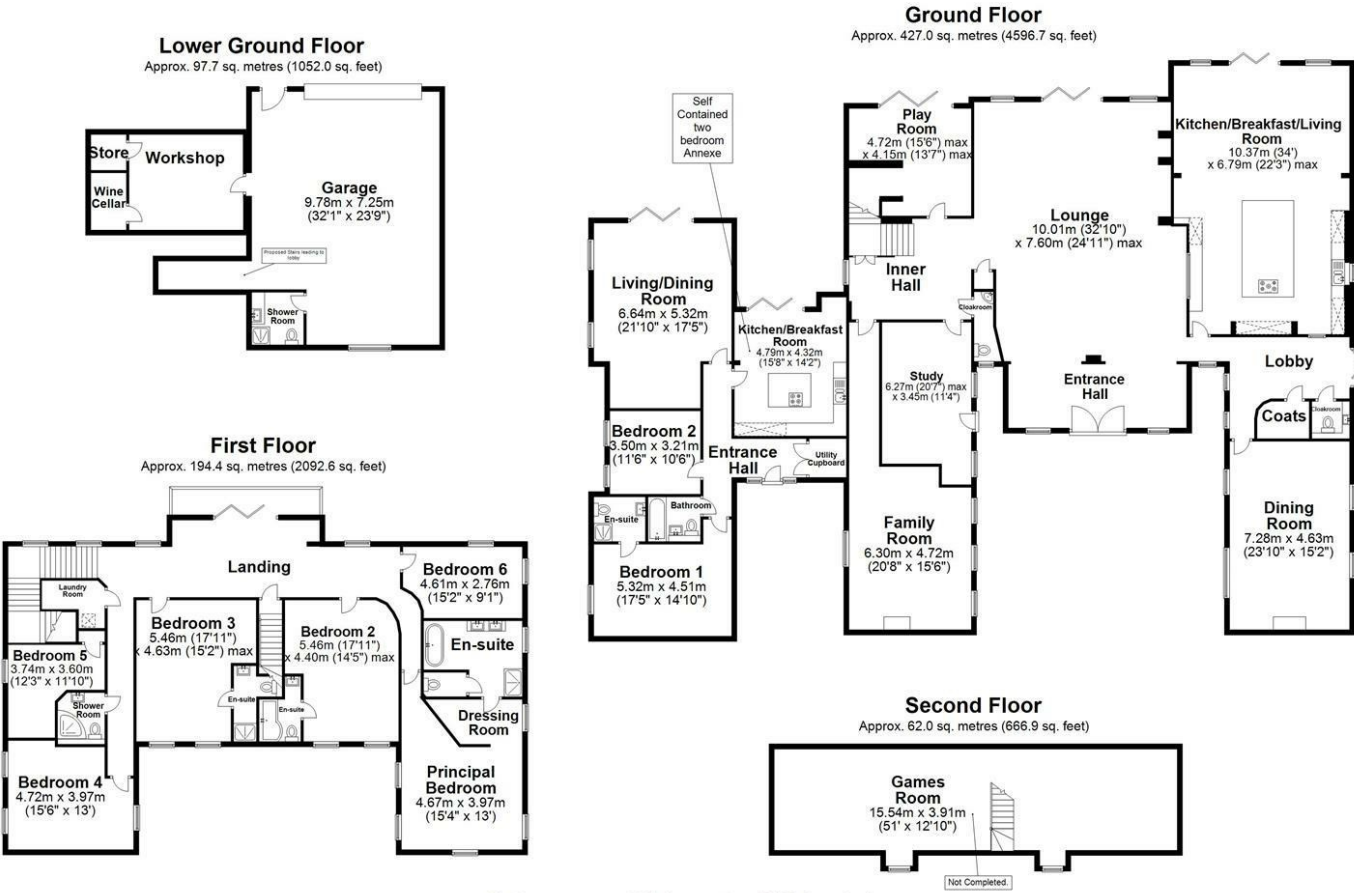

Total area: approx. 781.1 sq. metres (8408.2 sq. feet)  
Sketch layout only. Not to scale. Plan produced for Whittaker & Co.

Plan produced using PlantUp.

These particulars, whilst believed to be accurate are set out as a general outline only for guidance and do not constitute any part of an offer or contract. Intending purchasers should not rely on them as statements of representation of fact, but must satisfy themselves by inspection or otherwise as to their accuracy. No person in this firms employment has the authority to make or give any representation or warranty in respect of the property.

